

## 30W ECO DALI + PUSH Dimming power supply

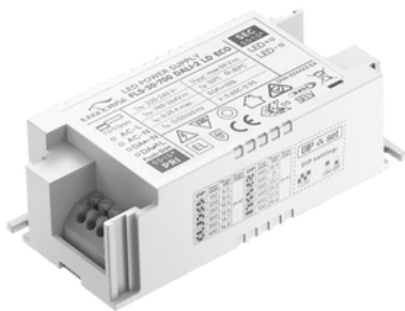

■ Approve



### Features

For luminaries of protection Class I , II , SELV , built-in/independent ( With side caps)

Input Voltage 220-240VAC

Protections: SCP/OLP/OVP/OTP

Power Factor :0.95

Efficiency :87%

Support DALI-2,Push Dimming

5 years warranty

### Applications

LED panel、 Spot light、 Down light

## Description

FLS-30-700 DALI-2 LD ECO is a 30W constant current LED driver with 150 to 700mA output current and a forward voltage range from 24 to 42VDC. The output current is adjustable by DIP Switch. With it's dimensions from 97 x 43 x 30 mm it is easy to integrate in LED panel, spot and down light products. To ensure trouble-free operation, protection is provided against output short circuit and over Load.

## Model code

FLS-30-700 DALI-2 LD ECO

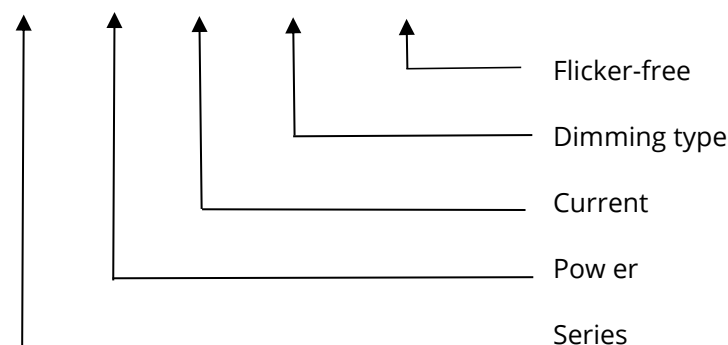

## Specification

	Constant Current (mA)	150	200	250	300	350	400	450	500	550	600	650	700	
Output	Voltage Range	24-42VDC												
	Unload voltage Max.	59VDC												
	Current Accuracy	±10%	±8%	±7%		±5%								
	Output HF current ripple(≥1KHz)	±5%												
	Output LF current ripple(≤120Hz)	±3%												
	SVM	≤0.01@Full Load												
	Pst	≤0.05@Full Load												
	Efficiency(Typ.)	87%												
	Input	Rated input voltage	220-240VAC											
Range of input voltage		198- 264 VAC												
Rated input voltage(DC)		198-280VDC												
Frequency(Hz)		0/50/60 Hz												
Displacement factor		≥0.9												
Power Factor		>0.95												
Input Current		0.25A max.												
Start-up time		<0. 7S												
No Load Power		≤0.5W												
Standby Power		≤0.5W												
THD (Typ.)		6%												
Dimming		THD (Typ.)	6%											
	Dimming	YES												
	Dimming mode	DALI-2 (IEC 62386-101,102,207) & Push Dimming (Corridor Function)												
	Dimming depth	1% ~100%												
Protection	Dimming current range	103-120%												
	Over Load Protection	YES/Latch off												
	Over Voltage Protection	>59VDC YES/Latch off												
	Short circuit Protection	YES/Latchoff												
	Over Temperature Protection	YES/AutoResume												
Environment	Operating Temperature	-20°C~+50°C												
	Humidity	20%-90%RH												
	Tc	80°C												
	Storage Temperature	-40°C~+80°C												
	Lifetime	>50000h,@Tc=80°C												
Surface	Dimension	97X43X30mm (Withsidecaps:131X43X30mm)												
s standards	EN61347-1; EN61347-2-13;EN62384; EN55015;EN61000-3-2 ;EN61000-3-3; EN61547;													

Others	ErP	EU 2019/2020
	RoHS	RoHS (2011/65/EU) (EU)2015/863
Note	<p>1.All parameters NOT specially mentioned are measured at 230VAC input , full load and 25°C of ambient temperature.</p> <p>2.Ripple &amp; Noise are measured at 20MHz of bandwidth by using a 300mm twisted pair-wire terminated with a 0.1uF &amp; 47 uF parallel capacitor.</p> <p>3.The DC input for this product is only used for emergency lighting and applies to functional and safety requirements, EMC is not considered.</p>	

## Parameter

Number	Output Current(mA)	Switch position			
		1	2	3	4
1	150	--	--	ON	--
2	200	ON	--	ON	--
3	250	--	ON	ON	--
4	300	ON	ON	ON	--
5	350	--	--	--	ON
6	400	ON	--	--	ON
7	450	--	ON	--	ON
8	500	ON	ON	--	ON
9	550	--	--	ON	ON
10	600	ON	--	ON	ON
11	650	--	ON	ON	ON
*1	700	ON	ON	ON	ON

\* Factory default

2

## Circuit Breaker

Ipeak	Tw idth	B10	B16	B20	C10	C16	C20
4.64A	4.16μs	22pcs	32pcs	38pcs	27pcs	41pcs	47pcs

**Wiring diagram**

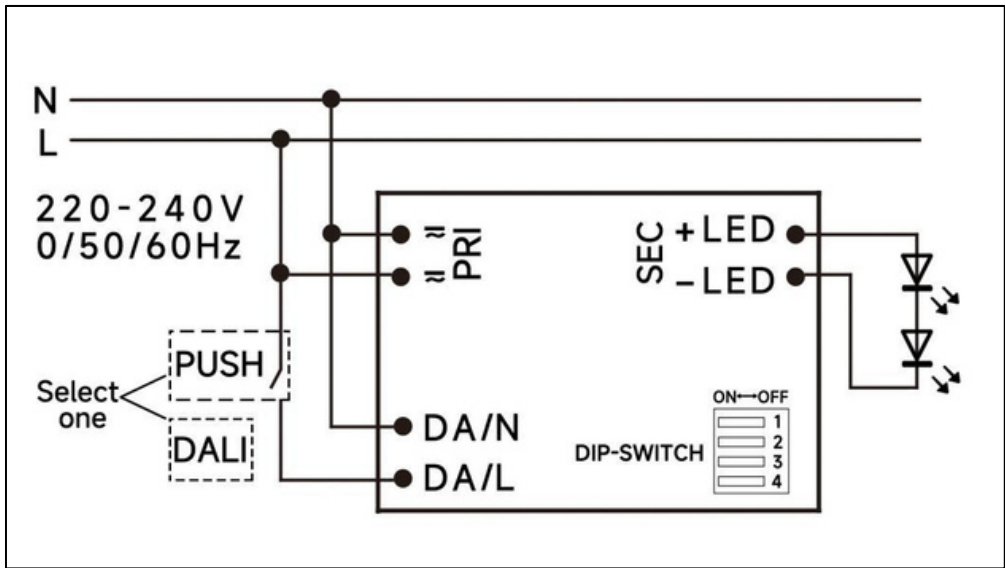

**2D diagram**

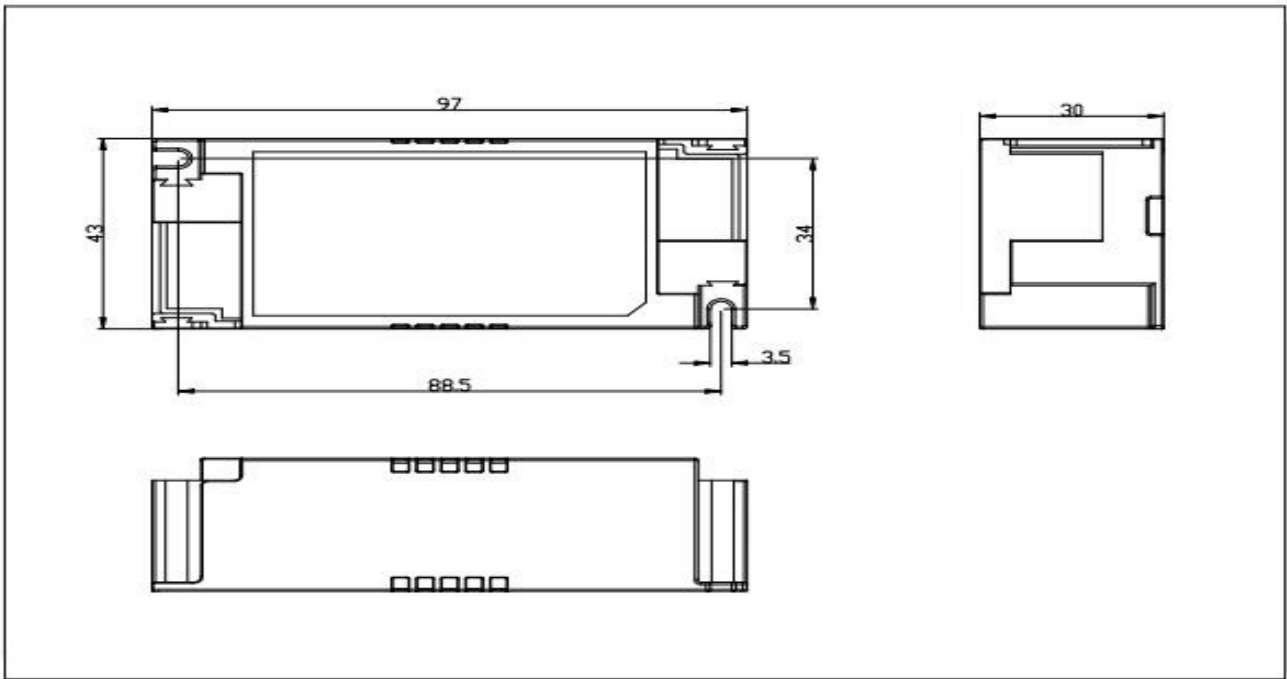

With side caps

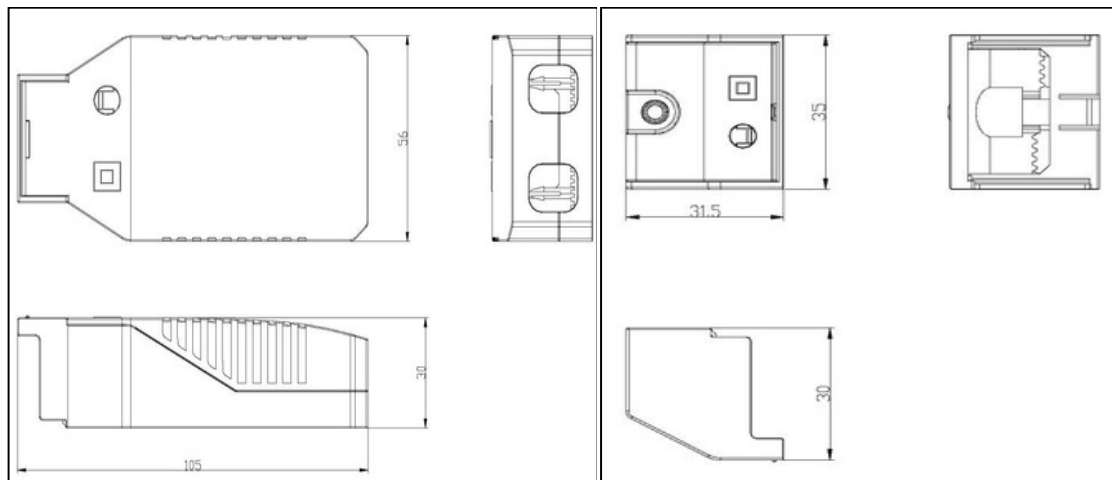
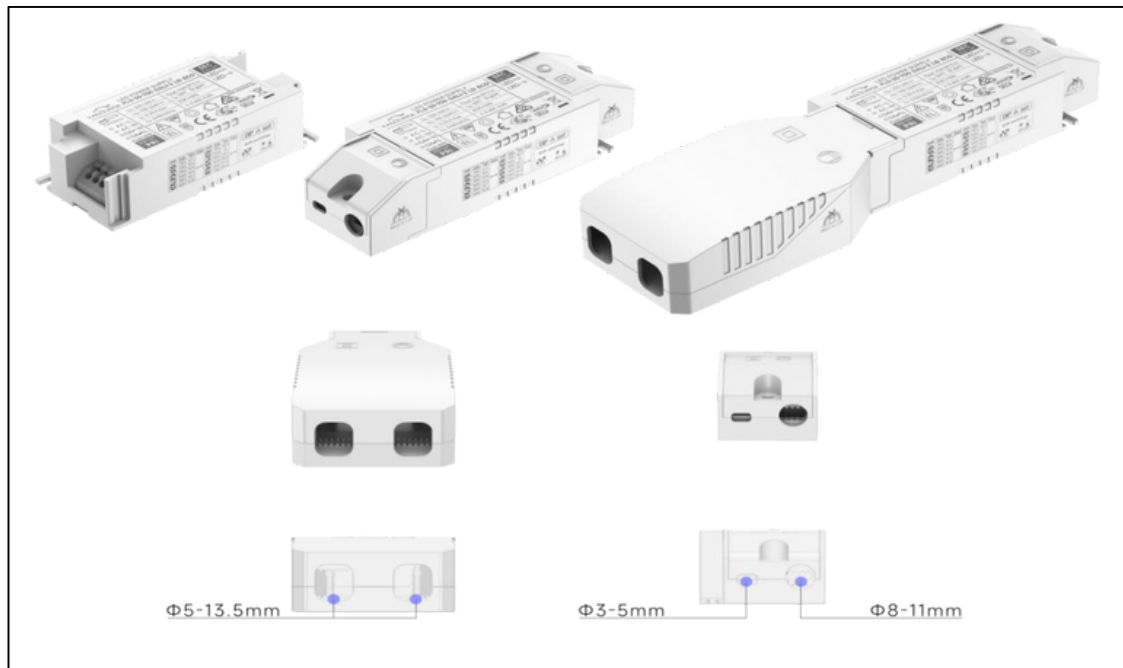

A caps

B caps

## Wiring & Connections

	Specification item	Value (Unit)
Input	Input wire cross-section	0.5...1.5 mm <sup>2</sup> (With A side caps: 0.75...2.5 mm <sup>2</sup> )
	Input wire gauge.	16...20 AWG (With A side caps: 14...20 AWG)
	Input wire strip length	7...9mm
Output	Output wire cross-section	0.5...1.5 mm <sup>2</sup>
	Output wire gauge.	16...20 AWG
	Output wire strip length	7...9mm

**Curve for FLS-30-700 DALI-2 LD ECO,  $I_o=700\text{mA}$**

Lifetime vs. Temperature Curve

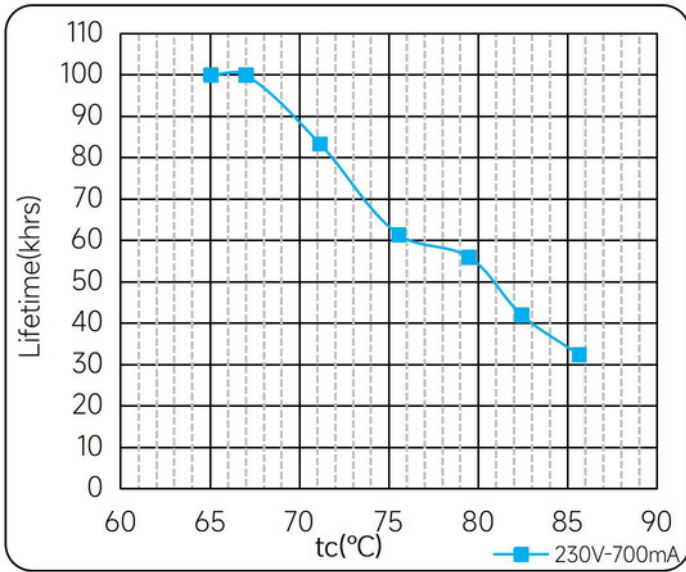

Efficiency vs. Load

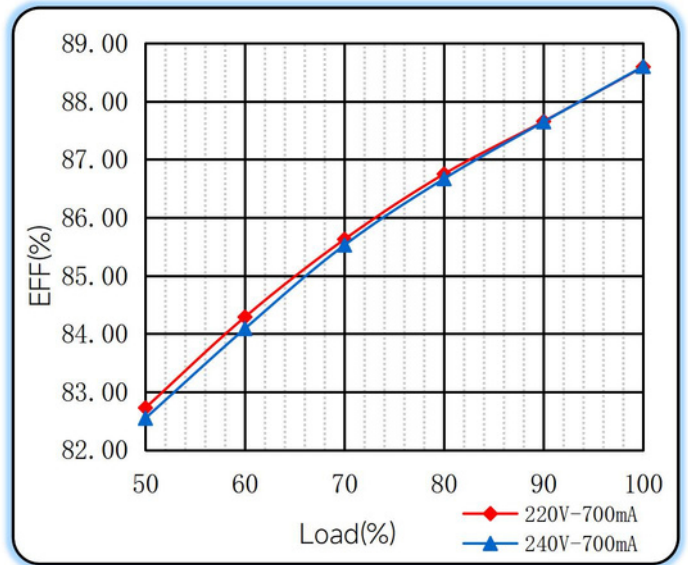

Power Factor Characteristics

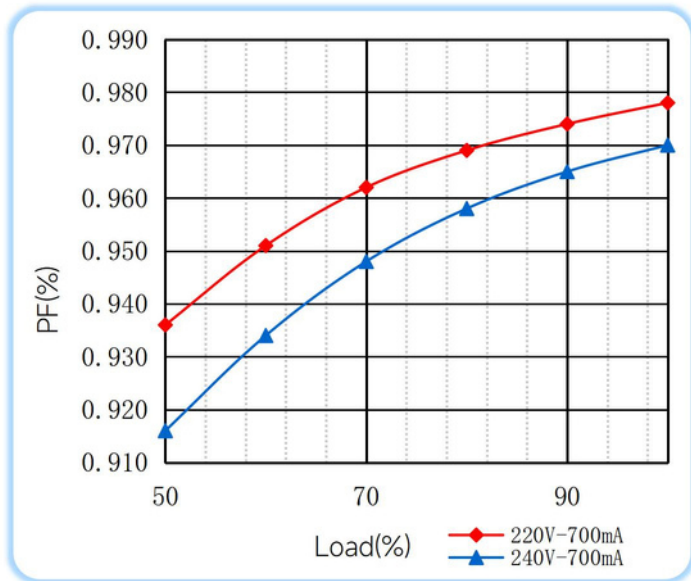

THD vs. Load

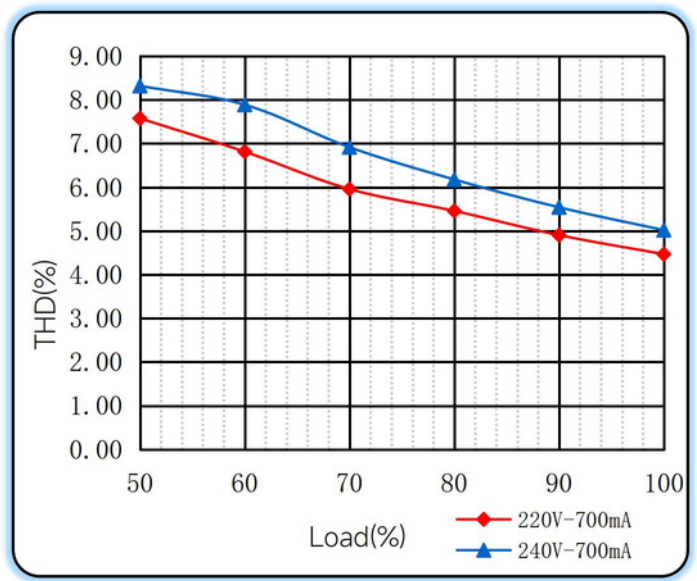

### Operating window

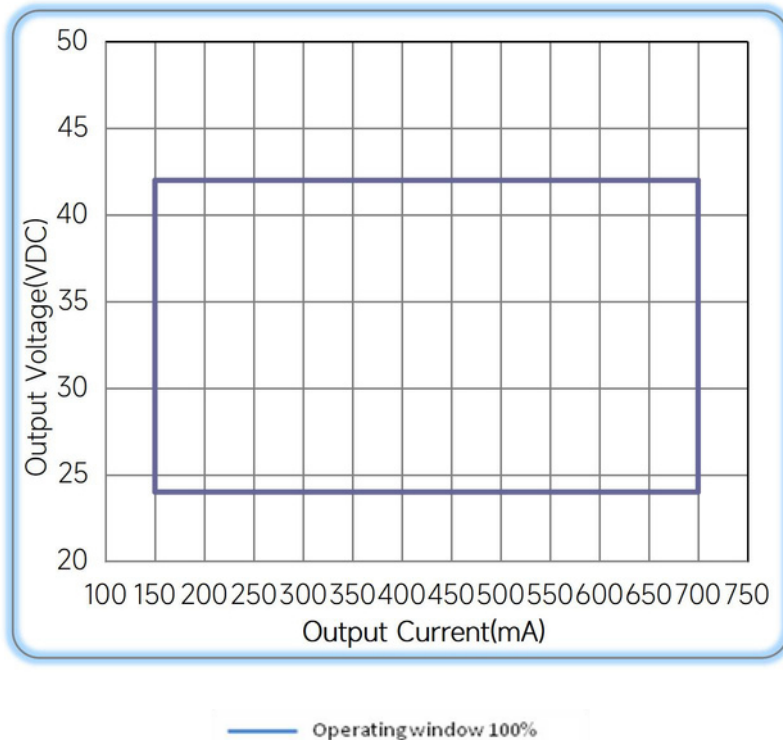

### Revision Updates

ITEM	BEFORE	AFTER	VERSION	DATE
Initial			A	2022/02/15
Start-up time	0.5S	0.7S	A	2022/08/12